

ZEBCO PS220J

DISCONTINUED

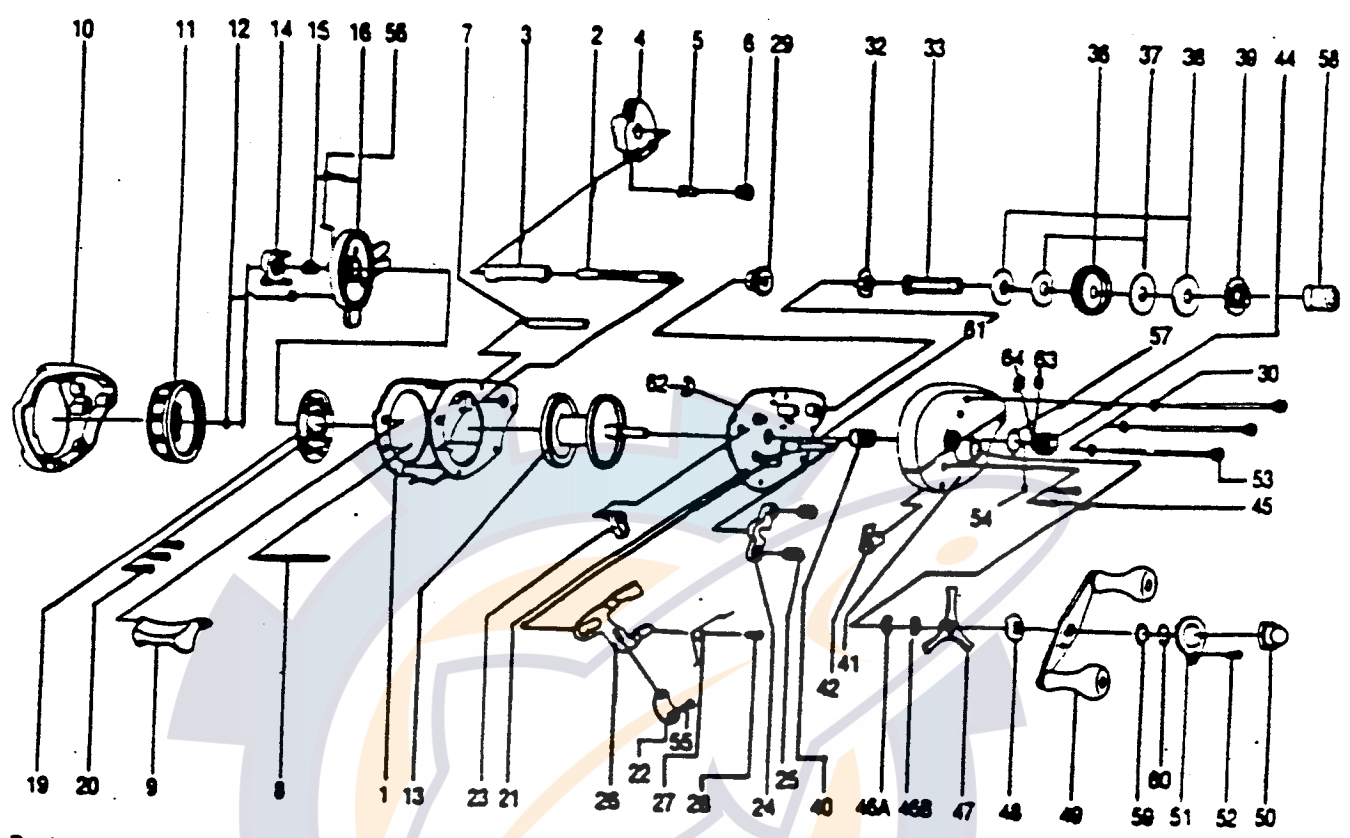

Key No.	Part No.	Description	Price	Key No.	Part No.	Description	Price
1	JW001	FRAME	5.80	38	JW045	DRAG WASHER	1.84
2	JW072	WORM SHAFT	6.14	39	JW091	ANTI-REVERSE RATCHET	1.84
3	JW016	WORM SHAFT GUARD	3.69	40	JW311	PINION GEAR ASSY.	2.83
4	JW347	LINE GUIDE	1.66	41	JW024	RIGHT SIDE COVER	9.11
5	JW006	LINE GUIDE PAWL	1.66	42	JW363	ANTI-REVERSE PAWL	.91
6	JW007	LINE GUIDE PAWL SCREW	1.78	44	JW333	CAST CONTROL CAP ASSY.	2.04
7	JW061	STABILIZER BAR	1.72	45	GX4352	RIGHT SIDE CVR SCR	1.16
8	JW094	FRAME FIXED PIN	1.46	46	JW046A	THICK WAVE WASHER	1.43
9	JW009	THUMB BAR	2.10	46	JW046B	THIN WAVE WASHER	1.33
10	JW323	LEFT SIDE COVER ASSY.	7.67	47	JW355	DRAG KNOB ASSY.	7.06
11	JW026	CONTROL DIAL	3.86	48	GX4660	HANDLE WASHER	1.23
12	JW101	O-RING CAST CONTROL	.56	49	JW318	HANDLE ASSY.	6.34
13	JW321	SPOOL ASSY.	10.75	50	GX4702	HANDLE NUT	.99
14	JW028	SLIDE CAM	.91	51	GX4703	HANDLE NUT LOCK	.91
15	JW071	SLIDE CAM SPRING	.85	52	GX4704	HANDLE NUT LOCK SCR	.42
16	JW351	SPOOL COVER	3.86	53	JW374	THUMB SCREW ASSY.	.43
19	JW330	MAGNET PLATE ASSY.	12.28	54	JW032	SPOOL TENSION KNOB	.49
20	JW076	MAGNET PLATE SCREW	1.28	55	JW100	LINK SCREW	.74
21	JW310	SET PLATE	8.00	56	JW108	CLICK CLAW	.91
22	JW036	LINK	1.23	57	JW105	TENSION KNOB O-RING	.91
23	JW050	THUMB BAR CAM	.99	58	JW058	CRANK SHAFT BUSHING	2.21
24	JW025	PINION YOKE	1.16	59	JW064	SHIM CRANKSHAFT	.49
25	JW040	PINION YOKE SPRING	.91	60	GX4657	CRANK SHAFT E-CLIP	.49
26	JW039	RELEASE SLIDER	2.27	61	JW002	SET PLATE SHAFT	1.23
27	JW102	TRIP SPRING	.91	62	GX4665	SHAFT CLIP-E	.49
28	JW057	RELEASE SLIDER SCREW	.91	63	JW082	CAST CONTROL CUSHION	.49
29	JW085	LEVEL WIND GEAR	3.14	64	JW038	SPOOL TN. KN. WSHR.-SC.	.49
30	GX109	WASHER-THUMB SCREW	.49				
32	JW083	TRIP RATCHET	1.23				
33	JW008	DRIVE SHAFT	3.69				
36	JW012	DRIVE GEAR	3.80				
37	JW059	DRAG DISC	1.46				

Prices subject to change without notice. Prices do not include postage and handling.

PLEASE ORDER BY PART NUMBER

Rev. 5/93

Zebco Division Brunswick Corporation, Box 270, Tulsa, OK 74101 USA 918-836-5581

